

Claw Setting Jig Set

410-785

- **1 Base (A)**
- **5 Setting jigs (B):** 4, 5, 6, & 8 prongs (two 5 prong jigs for different size wires)
- **3 Sleeves (C):** one for 4, 5, & 6 prong jigs and two different sizes for 8 prong jig
- **1 Sleeve shim (D):** for 8 prong jig

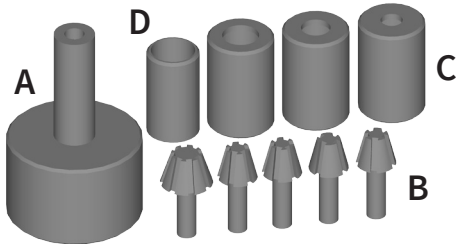

1. Select the one of the setting jigs (B) and insert it into the hole at the top of the base (A).
2. Cut your wires to length so that each piece sits in the jig with its end touching the other wires (see illustration below). Deburr the ends of each wire.
3. If you're creating an 8 prong setting, first slide the sleeve shim (D) over the base, followed by one of the two larger sleeves (C). For 4, 5, or 6 prong settings, use the sleeve with the smallest opening, without the sleeve shim.
4. With the wires held in place by the sleeve, solder them together. Because the jig is made of steel, it may be necessary to apply heat directly to the jig to warm it before soldering.

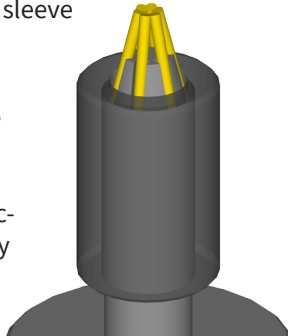

Contenti

The Contenti Company, Pawtucket, RI 02861 USA

5. Once the jig has cooled enough to handle, remove the sleeve and the setting. It may be necessary to re-heat the flux to release the setting.
6. Create one (or more) jumpings for the gallery of the setting and file grooves into the outside edge where the prongs will connect.
7. Solder the gallery jumpings in place (see illustration below).
8. Use a setting bur to create the prongs in the setting.
9. Depending on your design, either remove the wires below the gallery, or solder the setting directly to your ring shank.

